

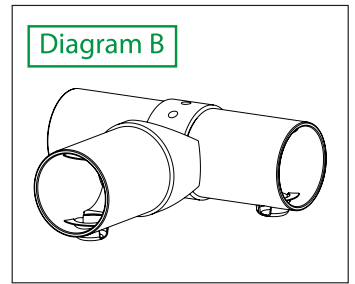

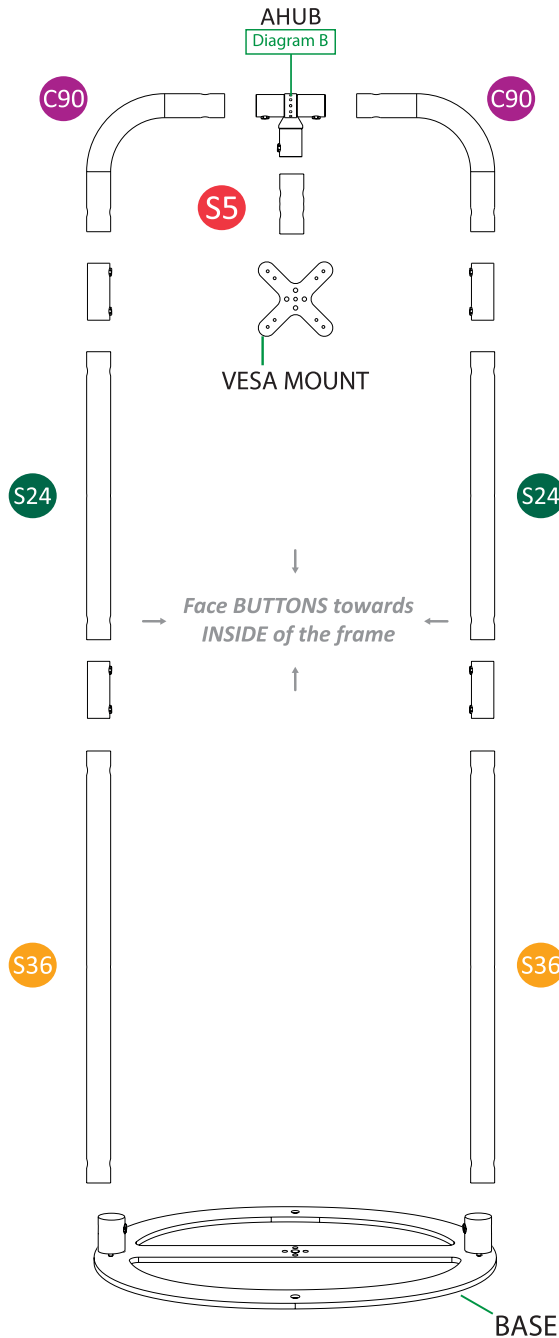

STEP 1. Layout all the parts on the floor in this form. Assembly of the tubes will be flat on the floor. Then stand the frame up to snap onto the base. The VESA mount and S5 tube will be snapped into place after the graphic is installed.

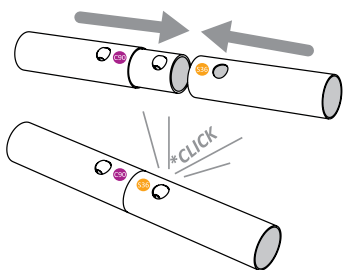

STEP 2. Push the button with your thumb while sliding the tubes together. Twist as needed to click the button into the hole.

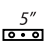
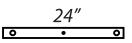
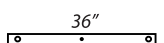

Parts Count:

-  **C90 (2x)**
-  **S5 (1x)**
-  **S24 (2x)**
-  **S36 (2x)**
-  **Diagram B (1x)**
- VESA MOUNT (1x)**
- BASE PLATE (1x)**

STEP 3. To install the graphic, slide it over the top and pull downward from the sides to reach the bottom. Be careful not to snag the fabric on the top VESA connector.

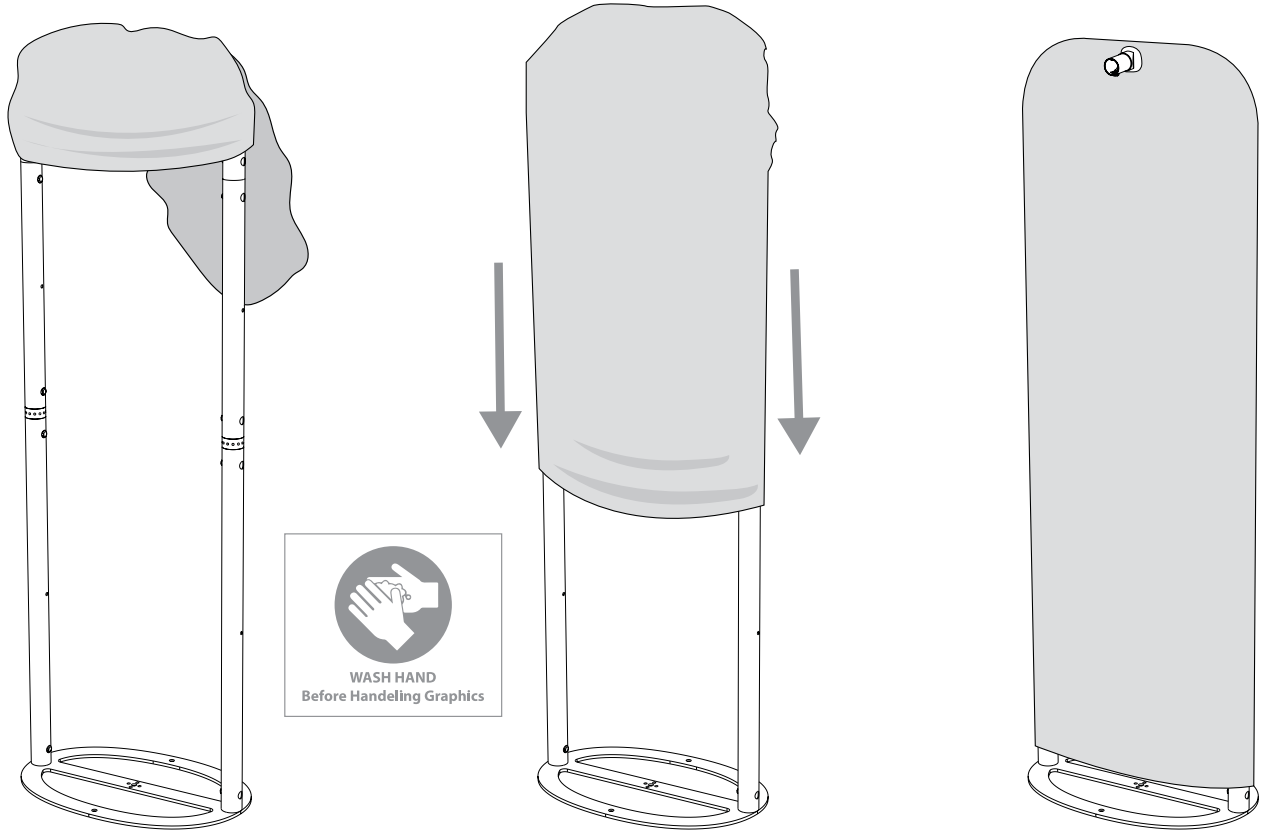

STEP 4. Install the VESA Mount. It may be easier to screw the VESA to your monitor or tablet first. If you ordered a tablet enclosure from us, it may already be attached to the VESA Mount.

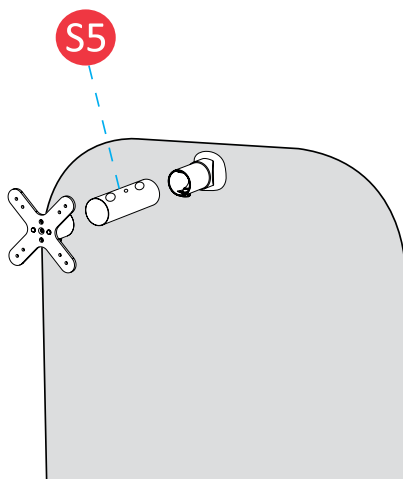

ASSEMBLED VIEW:

