

Assembly: The Monitor Arm needs to be snapped together before attaching it to the frame. Collect all the parts and arrange them like the diagram. Snap all the pieces together to complete the Monitor Arm assembly.

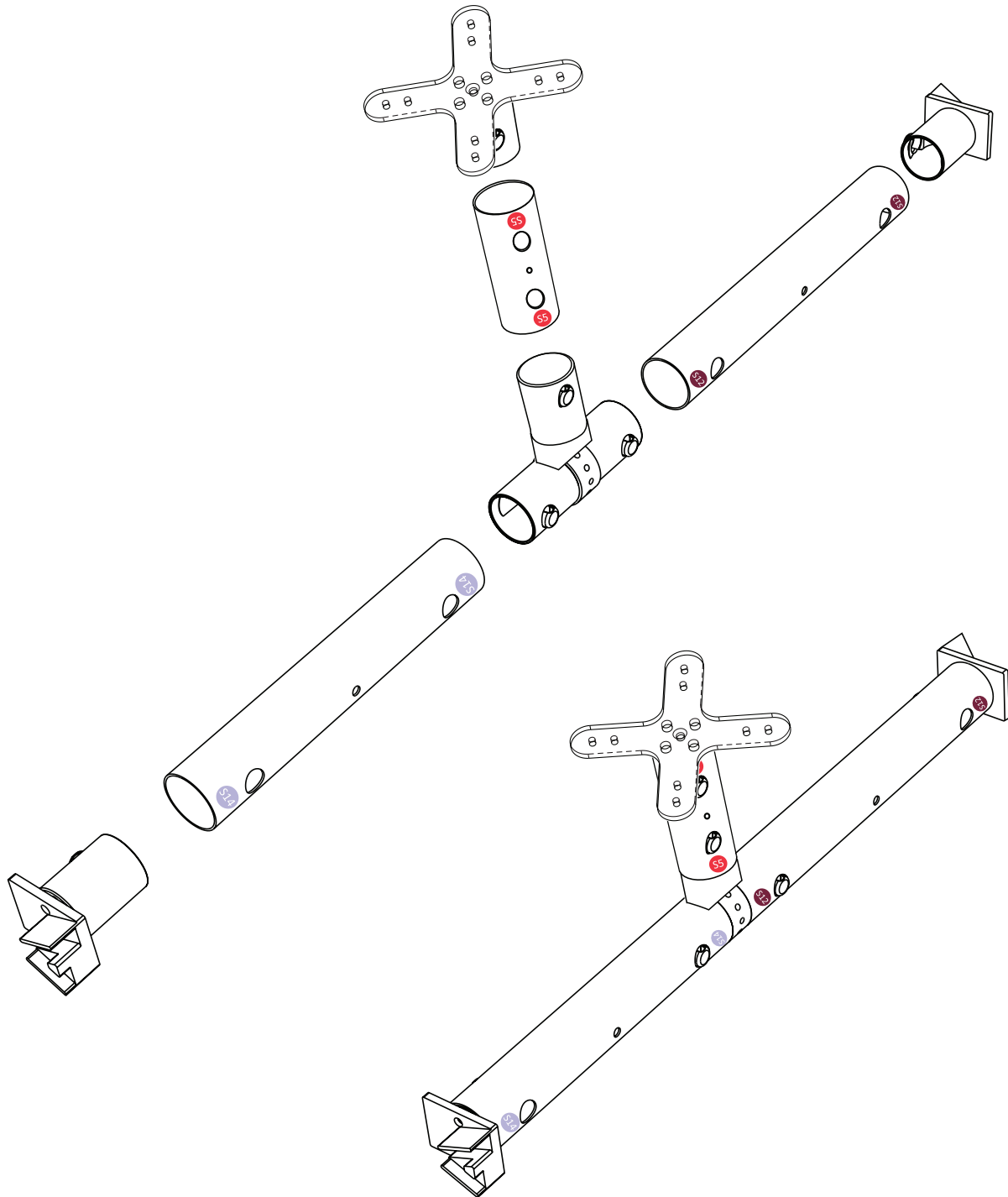

Installation: With the Monitor Arm assembled, and the display frame set up, behind the graphic, angle the Monitor Arm to fit into position (**A**). Secure the Monitor Arm (**B**) so the bracket slots into the frame (**C**). Next, angle the Monitor Arm to slot the other side bracket into the frame (**D**). It may take some pressure, pushing outward on the Monitor Arm and sliding the bracket into position.

Before you add your monitor, check the arm is secure by trying to shake or rotate the arm out of position.

Remove the Monitor Arm before collapsing the display frame.

