

TIGHTENING SPRING (1)

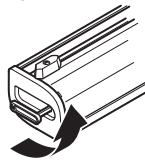

TIGHTENING SPRING (2)

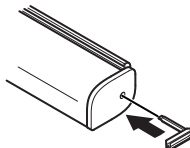

LOCKING MECHANISM

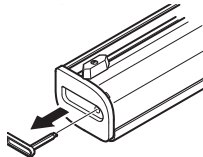

TENSION RELEASE (1)

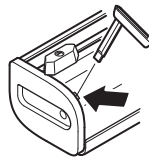

TENSION RELEASE (2)

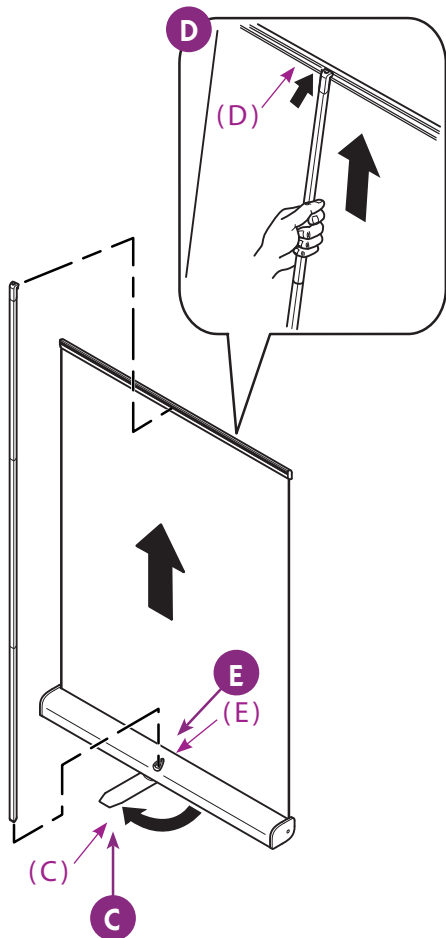

SETUP INSTRUCTIONS

Step 1: Remove the pole (A) from the under side of the display housing by rotating the securing tabs (B) to the horizontal position.

Step 2: Rotate the foot on the bottom of the base (C) to a 90° position.

Step 3: Assemble the pole.

Step 4: Pull out the graphic and insert the tab on top of the pole (D) into the groove on the top profile.

Step 5: Step on the foot of the base to hold it in place as you pull the graphic up using the pole – insert the pole into the hole (E) on the base. Make sure the pole is fully inserted (about 2" into the base).

Note: When collapsing the stand it is important to hold the graphic with your hand to avoid damage to the graphics.

PARTS

- (A) Three Part Pole
- (B) Securing Tabs
- (C) Base
- (D) Top Profile Groove
- (E) Base Hole

ASSEMBLED VIEW

